

Ku-Band Band-Pass Filter

10.7-12.75 GHz, High Rejection and low VSWR

DESCRIPTION

Anteral's **filters (FILT)** and **multiplexers (MUX)** are available in different bands covering the frequency range from 3 GHz to 110 GHz. COTSs and custom designs are available.

All filters and multiplexers are designed for minimum footprint and low mass. In addition, optimized assemblies for custom topologies can be requested. The filters and diplexers are small and compact by design. Low insertion losses and cutoff rejections are obtained depending on the structure.

The BPF-SAT-KU-01 model operates from 10.7 to 12.75 GHz. This band-pass filter rejects 25 dB from DC to 9 GHz and 75 dB from 13.75 to 16 GHz. The filter is configured with a SMA female connector for both ports.

APPLICATIONS

Filters are especially useful when not only high rejection and low insertion loss but also compact size is required. Therefore, these filters are widely used in space, radar, communications and SATCOM applications, among others.

Anteral also offers their **Diplexers (DPX)** from 3 GHz to 110 GHz.

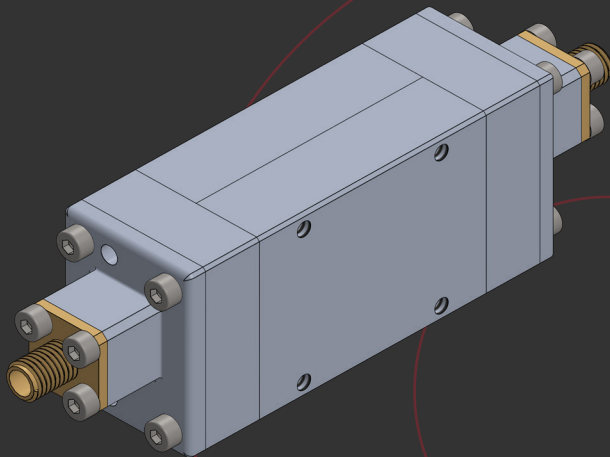

ELECTRICAL SPECIFICATIONS

Parameter	Typical value
Pass band	10.7 - 12.75 GHz
Return Loss	20 dB
Insertion Loss	0.25 dB
Low Rejected Band	DC - 9 GHz
Low Band Rejection	> 25 dB
High Rejected Band	13.75 - 16 GHz
High Band Rejection	> 75 dB

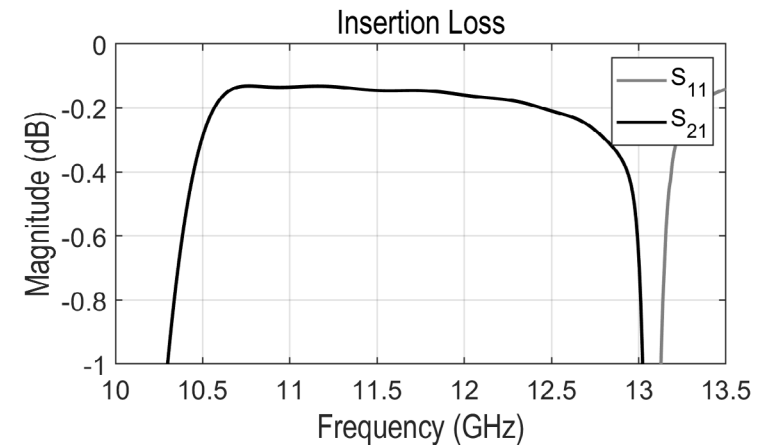
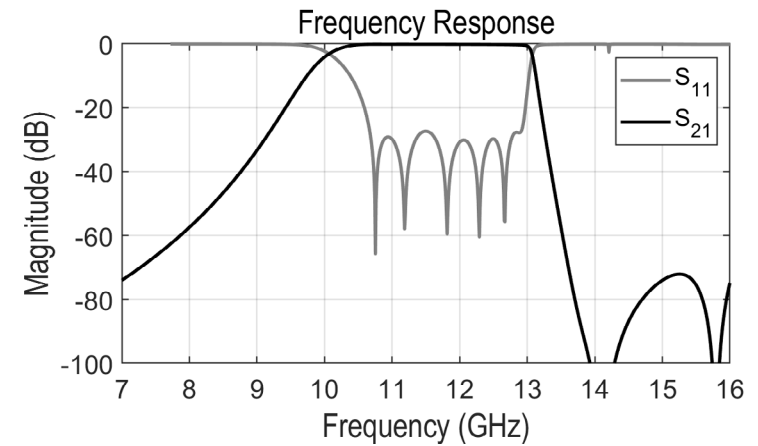

Additional notes

All values correspond to simulation data. Actual values could vary slightly.
The return loss performance of all items is checked before delivery.

Last version: 05/07/2023.

MECHANICAL OUTLINE

Parameter	Description
Ports	SMA Female Connector
Flange	Four Holes
Size	23 x 30 x 105.1 mm
Total weight	115 g
Material	Aluminum + Surtec 650V

